

CJ1 Series

乾式單板標準超薄型電磁離合器 Dry Single-plate Magnetic Clutch

附導座 with plating hub

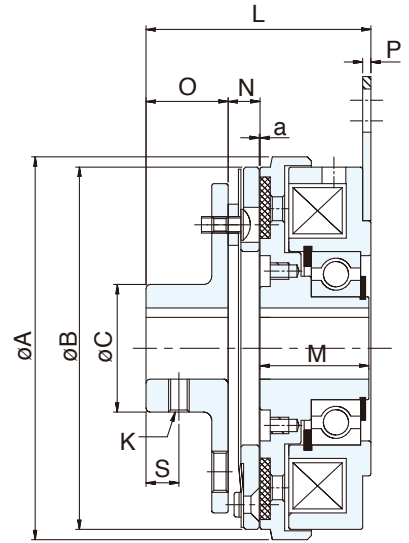
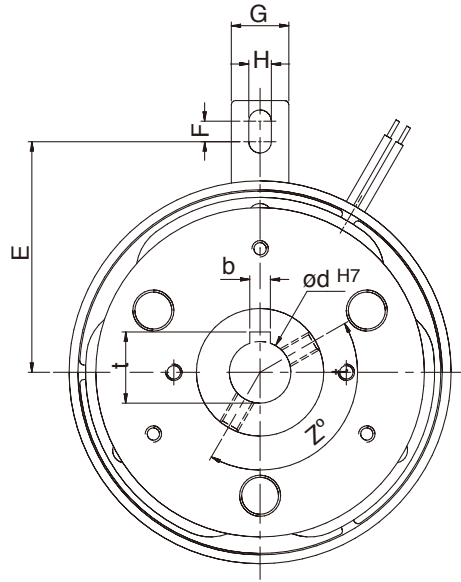

型號 MODEL		CJ10S6AA(AB)	CJ11S5AA(AB)	CJ12S5AA(AB)	CJ100S5AA(AB)	CJ1010AA(AB)	CJ1020AA(AB)	
靜摩擦轉距 Static Friction Torque	[kgm](Nm)	0.55 (5.5)	1.1 (11)	2.2 (22)	4.5 (45)	9.0 (90)	17.5 (175)	
動摩擦轉距 Dynamic Friction Torque	[kgm](Nm)	0.5 (5.0)	1.0 (10)	2.0 (20)	4.0 (40)	8.0 (80)	16 (160)	
功率 Power	[24V](W) at 20°C	14	22	26	29	37	44	
徑 方 向 Radius	A	74	93	116	144	178	225	
	B	70	88	110	137	172	217	
	C	27.5	31	41	49	65	83	
	E	39.75	56	61.45	77.15	99	117	
	F	5	5	4.3	4.9	10	10	
	G	12	14	16	16	25	25	
軸 方 向 Shaft	H	4.5	5.5	6.5	6.5	8.5	8.5	
	K	M5	M5	M6	M6	M8	M8	
	L	45.2	54.75	64.1	73.6	93.8	111.2	
	M	25	26.5	30.1	34	43	50	
	N	6.2	7.75	9	10.9	12.8	16.2	
	O	15	20	25	30	38	45	
	P	2	2	2	2	3	3	
	S	6	8	10	12	14	18	
	d	15(12)	20(15)	25(20)	30(25)	40(30)	50(40)	
	b	5(4)	5	7(5)	7	10(7)	10	
	t	17.3(13.8)	22.3(17.3)	28.3(22.3)	33.3(28.3)	43.8(33.3)	53.8(43.8)	
	a	0.2 (±0.05)			0.3 (^{+0.05} / _{-0.1})		0.5 (⁻⁰ / _{-0.2})	
	Z°	150°					120°	
重量 Weight	(kg)	0.6	1.1	1.9	3.4	7.2	13	
保護素子 Protective band		470KD07	GD80KD10		GD80KD14			